

TYPICAL X-SECTION
 STA. 0+25 TO STA. 4+50
 Scale: 1" = 20'

GENERAL NOTES

1. All work shall be done in accordance with the specifications and standards of the City of San Bernardino.
2. All materials shall be of the best quality and shall be approved by the City Engineer.
3. All work shall be done in accordance with the specifications and standards of the City of San Bernardino.

APPROVED	1/23/2	1962
REGISTERED CIVIL ENGINEER		
CITY ENGINEER		
DRAWING NO. 3357	DESIGNED BY: S. Stone	
SHEET 1 OF 1	CHECKED BY: J. H. H. H.	
1 SHEETS		

DEPARTMENT OF ENGINEERING
 CITY OF SAN BERNARDINO
 CURB, GUTTER, PAVING AND SIDEWALK
 EAST SIDE ARROWHEAD AVENUE FROM
 FOURTH STREET TO A POINT 530' SOUTH

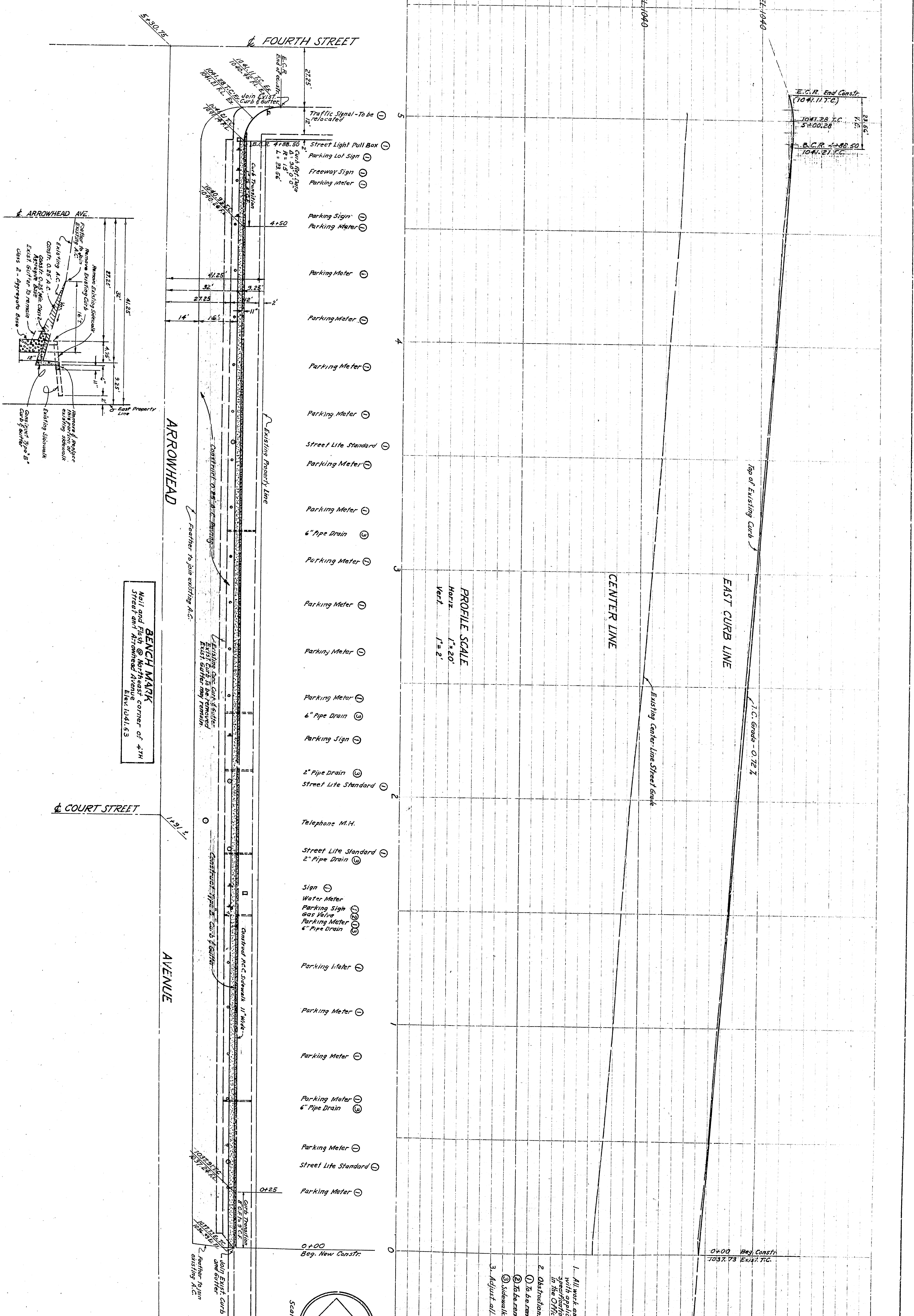

TYPICAL X-SECTION
 STA. 0+25 TO STA. 4+50
 Scale: 1" = 20'

GENERAL NOTES

1. All work shall be done in accordance with the specifications for the project.
2. All work shall be done in accordance with the specifications for the project.
3. All work shall be done in accordance with the specifications for the project.

APPROVED: [Signature]
 REGISTERED CIVIL ENGINEER
 CITY OF SAN BERNARDINO
 DRAWING NO. 3357
 SHEET 1 OF 1
 CHECKED BY: [Signature]
 DEPARTMENT OF ENGINEERING
 CITY OF SAN BERNARDINO
 CURB, GUTTER, PAVING AND SIDEWALK
 EAST SIDE ARROWHEAD AVENUE FROM
 FOURTH STREET TO A POINT 530' SOUTH